

Soils Map

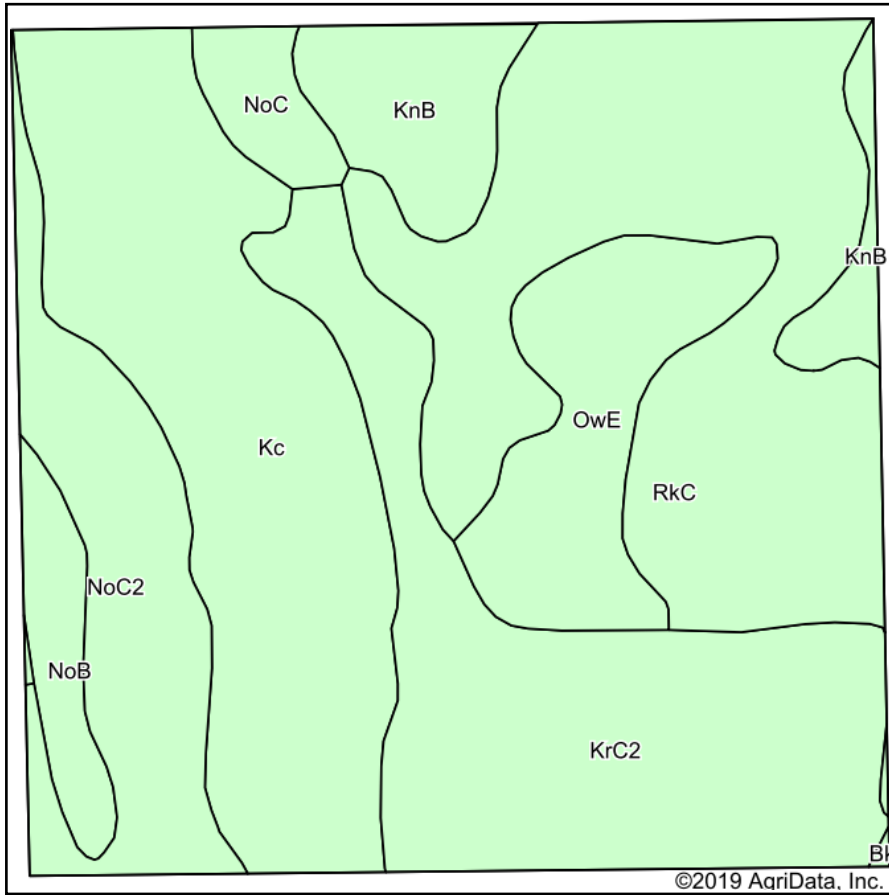

Soils data provided by USDA and NRCS.

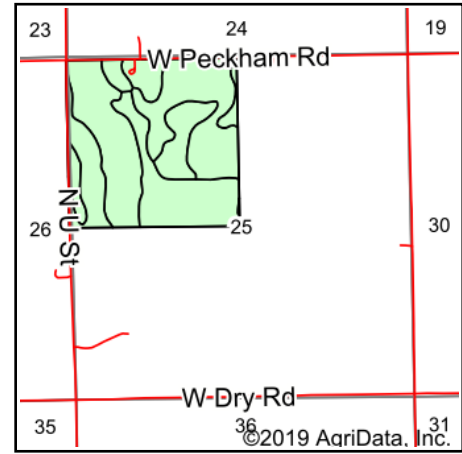

State: **Oklahoma**
 County: **Kay**
 Location: **25-28N-1E**
 Township: **Newkirk**
 Acres: **158.46**
 Date: **3/25/2019**



Maps Provided By:



© AgriData, Inc. 2019

www.AgriDataInc.com



Area Symbol: OK071, Soil Area Version: 15

Code	Soil Description	Acres	Percent of field	Non-Irr Class *c	Irr Class *c	Range Production (lbs/acre/yr)	Introduced bluestem	Improved bermudagrass	Alfalfa hay	Alfalfa hay Irrigated	Grain sorghum	Grain sorghum Irrigated	Wheat	Cotton lint	Peanuts	Sorghum hay
RkC	Renfrow-Kirkland complex, 3 to 5 percent slopes	41.06	25.9%	IIIe		3887			4		17		20	100		
Kc	Port silty clay loam, 0 to 1 percent slopes, occasionally flooded	36.75	23.2%	IIw		6049			9	5	50		35	26	48	
KrC2	Kirkland-Renfrow complex, 3 to 5 percent slopes, eroded	33.08	20.9%	IIIe		0			4		4		18			
NoC2	Milan loam, 3 to 5 percent slopes, eroded	16.19	10.2%	IIIe		0					44		25	9		
OwE	Highview clay, 8 to 15 percent slopes	13.45	8.5%	VIe		1953										
KnB	Kirkland silt loam, 1 to 3 percent slopes	9.95	6.3%	IIs	IIs	3926	5		4		34		33	50		
NoB	Milan loam, 1 to 3 percent slopes	4.49	2.8%	IIe	IIe	4747				7	53	105	30	19		
NoC	Milan loam, 3 to 5 percent slopes	3.40	2.1%	IIIe		4747					48		28	11		



Bk	Grainola-Ashport, frequently flooded, complex, 0 to 12 percent slopes	0.09	0.1%	IVe		4306	4	4								
Weighted Average						3061.2	0.3	4.2	1.2	0.2	26	3	23.1	36.8	11.1	

*n: The aggregation method is "Weighted Average using major components"

*c: Using Capabilities Class Dominant Condition Aggregation Method

Soils data provided by USDA and NRCS.