

Soils Map

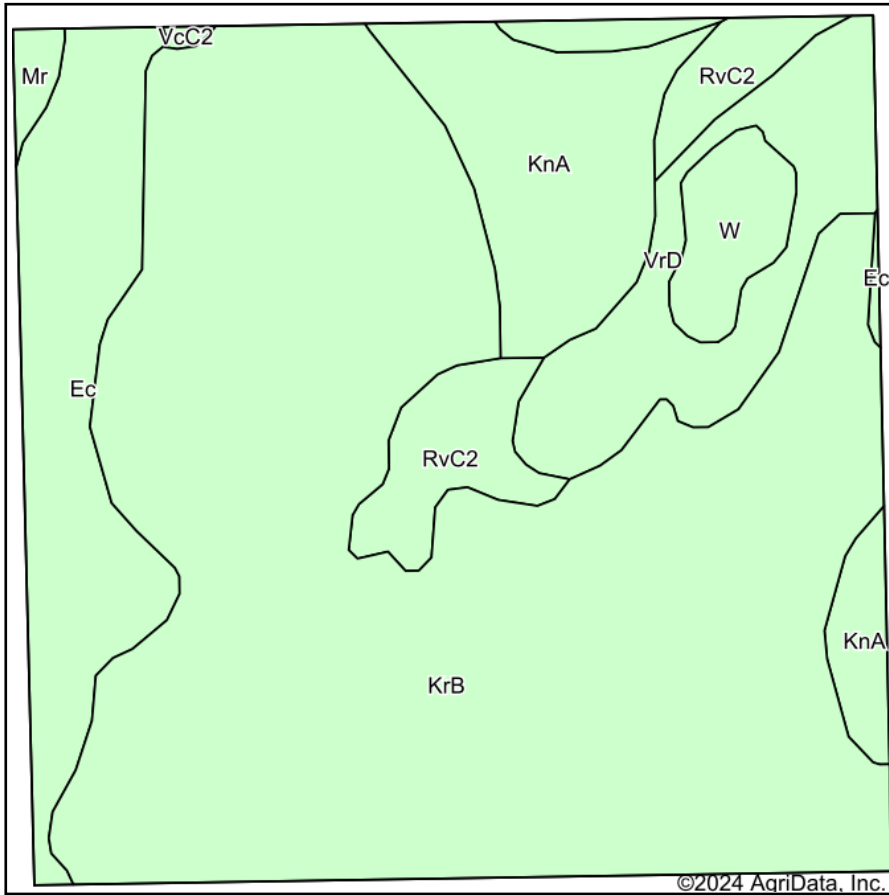

Soils data provided by USDA and NRCS.

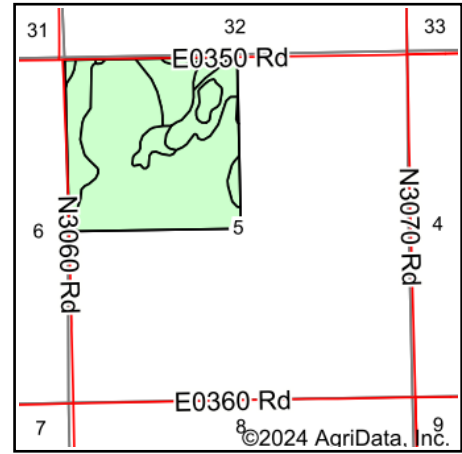

State: **Oklahoma**
 County: **Garfield**
 Location: **5-23N-3W**
 Township: **North Garfield**
 Acres: **158.26**
 Date: **7/3/2024**



Maps Provided By:



© AgriData, Inc. 2023

www.AgriDataInc.com



Area Symbol: OK047, Soil Area Version: 20

| Code | Soil Description | Acres | Percent of field | Non-Irr Class *c | Irr Class *c | Range Production (lbs/acre/yr) | Alfalfa hay Tons | Barley Bu | Corn Bu | Cotton lint Lbs | Grain sorghum Bu | Improved bermudagrass AUM | Introduced bluestem AUM | Oats Bu | Peanuts Lbs | Soy hay |
|------|---|--------|------------------|------------------|--------------|--------------------------------|------------------|-----------|---------|-----------------|------------------|---------------------------|-------------------------|---------|-------------|---------|
| KrB | Kirkland-Renfrow complex, 1 to 3 percent slopes | 102.13 | 64.5% | IIIe | | 3901 | | 12 | | 238 | 32 | 4 | | 2 | | |
| Ec | Masham clay, 3 to 12 percent slopes | 16.59 | 10.5% | VIe | | 2185 | | | | | | 3 | 1 | | | |
| KnA | Kirkland silt loam, 0 to 1 percent slopes, cool | 15.11 | 9.5% | IIIs | IIIs | 3890 | | 4 | | 22 | 35 | 4 | 5 | 34 | | |
| VrD | Grainola-Masham-Ironmound complex, 5 to 12 percent slopes | 12.13 | 7.7% | VIe | | 3015 | | 2 | | | | 2 | | | | |
| RvC2 | Renthin-Masham complex, 3 to 5 percent slopes, eroded | 7.36 | 4.7% | IIIe | | 237 | | 15 | | 15 | 17 | 4 | | 18 | | |
| W | Water | 3.83 | 2.4% | VIII | | 0 | | | | | | | | | | |

Soils data provided by USDA and NRCS.



| Code | Soil Description | Acres | Percent of field | Non-Irr Class *c | Irr Class *c | Range Production (lbs/acre/yr) | Alfalfa hay Tons | Barley Bu | Corn Bu | Cotton lint Lbs | Grain sorghum Bu | Improved bermudagrass AUM | Introduced bluestem AUM | Oats Bu | Peanuts Lbs | So hay |
|-------------------------|--|-------|------------------|------------------|--------------|--------------------------------|------------------|-----------|-----------|-----------------|------------------|---------------------------|-------------------------|------------|-------------|--------|
| Mr | Miller clay, 0 to 1 percent slopes, occasionally flooded | 0.92 | 0.6% | IVw | | 4295 | 4 | | 2 | 395 | 57 | 7 | | | | 48 |
| VcC2 | Grainola-Masham complex, 3 to 5 percent slopes, eroded | 0.19 | 0.1% | IVe | | 0 | | 2 | | | | 2 | 1 | | | |
| Weighted Average | | | | 3.67 | *- | 3385 | *- | 9 | *- | 158.7 | 25.1 | 3.7 | 0.6 | 5.4 | 0.3 | |

*n: The aggregation method is "Weighted Average using all components"

*c: Using Capabilities Class Dominant Condition Aggregation Method

*- Irr Class weighted average cannot be calculated on the current soils data due to missing data.