

# Soils Map

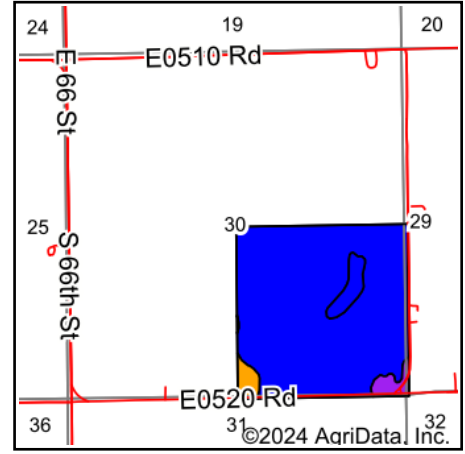

State: **Oklahoma**  
 County: **Garfield**  
 Location: **30-21N-5W**  
 Township: **South Garfield**  
 Acres: **160.64**  
 Date: **10/15/2024**

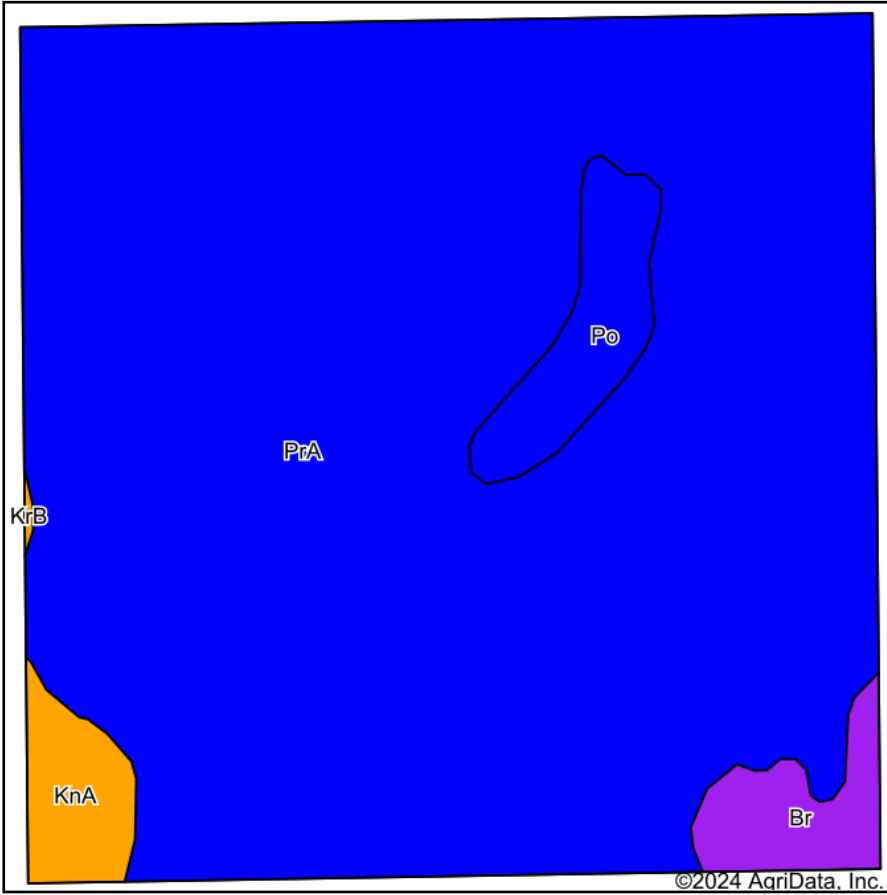

Soils data provided by USDA and NRCS.

Area Symbol: OK047, Soil Area Version: 20

Code	Soil Description	Acres	Percent of field	Non-Irr Class Legend	Non-Irr Class *c	Irr Class *c	Range Production (lbs/acre/yr)	Alfalfa hay Tons	Barley Bu	Caucasian bluestem AUM	Cotton lint Lbs	Grain sorghum Bu	Improved bermudagrass AUM	Introduced bluestem AUM	Oats Bu
PrA	Port silt loam, 0 to 1 percent slopes, occasionally flooded	146.49	91.2%		Ilw	Ilw	5795	5			13	49	9		
Po	Port clay loam, 0 to 1 percent slopes, occasionally flooded	5.73	3.6%		Ilw		6127	5			13	49	9		
Br	Pulaski and Ashport soils, 0 to 1 percent slopes, frequently flooded	4.39	2.7%		Vw		6300			1	25	3	8		
KnA	Kirkland silt loam, 0 to 1 percent slopes, cool	3.93	2.4%		Ills	Ills	3890		4		22	35	4	5	3
KrB	Kirkland-Renfrow complex, 1 to 3 percent slopes	0.10	0.1%		Ille		3901		12		238	32	4		

Soils data provided by USDA and NRCS.



Code	Soil Description	Acres	Percent of field	Non-Irr Class Legend	Non-Irr Class *c	Irr Class *c	Range Production (lbs/acre/yr)	Alfalfa hay Tons	Barley Bu	Caucasian bluestem AUM	Cotton lint Lbs	Grain sorghum Bu	Improved bermudagrass AUM	Introduced bluestem AUM	Oats Bu
<b>Weighted Average</b>					<b>2.11</b>	<b>*-</b>	<b>5772.9</b>	<b>4.7</b>	<b>0.1</b>	<b>*-</b>	<b>13.7</b>	<b>47.4</b>	<b>8.8</b>	<b>0.1</b>	<b>0.</b>

\*n: The aggregation method is "Weighted Average using all components"

\*c: Using Capabilities Class Dominant Condition Aggregation Method

\*- Irr Class weighted average cannot be calculated on the current soils data due to missing data.